

Plumbing · Heating · Gas · Industrial · Actuation · Hydraulics



T-CS-4000

Full Port Carbon Steel Ball Valve

-
- Safety Factor: 2 to 1
 - Pom Ball Seats
 - Vitom Stem Seal
 - Lockable Handle
 - 1/4"-1" Block Body
 - 1-1/4"-2" Rounded Body
 - 100% Leak Tested
 - Lockable Handle



www.jomarvalve.com

Carbon Steel Ball Valve



3 Piece • Full Port • Threaded Connection • 7250 WOG

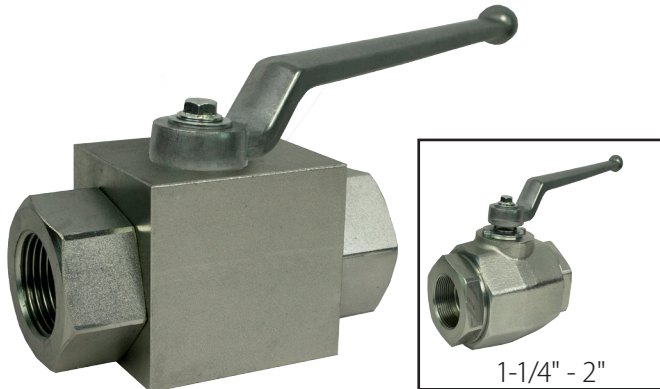

T-CS-4000

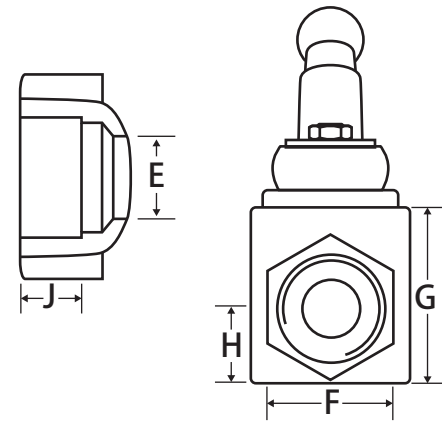
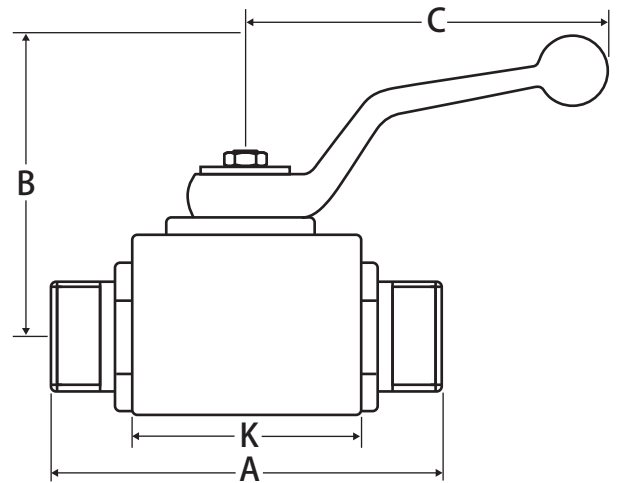

Features

- Body pressure ratings:
 - 7250 PSI for 1/4" to 1/2"
 - 5500 PSI for 3/4" to 2"
- Safety factor: 2 to 1
- Pom ball seats
- Viton stem seal
- Lockable handle
- Sizes 1/4" to 1" one block body design
- 1-1/4" to 2" are rounded body design
- 100% leak tested
- Wetted surfaces contain less than .25% lead content

Material Specifications

| Part | Materials |
|-----------------|----------------------------|
| Body | Carbon Steel |
| Ball | Chrome Plated Carbon Steel |
| Seat (2) | POM |
| Seat O-Ring (2) | FMP |
| Stem | Carbon Steel |
| Stem Seal | POM |
| Stem O-Ring | FMP |
| Travel Stop | Carbon Steel |
| Stopping Plate | Carbon Steel |
| Handle | Casted Zinc |
| Screw | Carbon Steel |

Valve Seat Rating

6000 WOG, Temperature rating: 14°F to 176°F

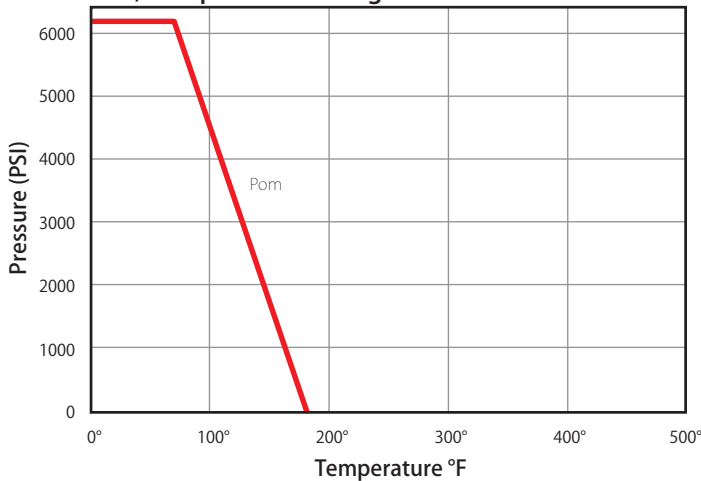

Dimensions

| Part No. | List Price | Size | A | B | C | E | F | G | H | J | K |
|----------|------------|--------|------|------|------|------|------|------|------|------|------|
| 100-941 | \$29.91 | 1/4" | 1.57 | 3.30 | 4.41 | 0.24 | 1.02 | 1.30 | 0.53 | 0.55 | 1.57 |
| 100-942 | \$32.31 | 3/8" | 1.65 | 3.42 | 4.41 | 0.39 | 1.26 | 1.42 | 0.63 | 0.55 | 1.65 |
| 100-943 | \$38.23 | 1/2" | 1.89 | 3.57 | 4.41 | 0.47 | 1.38 | 1.57 | 0.67 | 0.63 | 1.89 |
| 100-944 | \$64.20 | 3/4" | 2.36 | 4.27 | 6.10 | 0.79 | 1.89 | 2.17 | 0.98 | 0.71 | 2.36 |
| 100-945 | \$81.60 | 1" | 2.56 | 4.62 | 6.10 | 0.98 | 2.24 | 2.52 | 1.12 | 0.83 | 2.56 |
| 100-946 | \$160.74 | 1-1/4" | 2.95 | 5.45 | 9.25 | 1.26 | 2.60 | 2.95 | 1.30 | 0.87 | 2.95 |
| 100-947 | \$216.69 | 1-1/2" | 3.58 | 5.96 | 9.25 | 1.50 | 3.15 | 3.46 | 1.57 | 0.94 | 3.58 |
| 100-948 | \$314.78 | 2" | 3.94 | 6.59 | 9.25 | 1.89 | 3.78 | 4.09 | 1.89 | 1.02 | 4.33 |