

Lockwing



Utility Gas Ball Valve • Full Port • Service Bypass • 125 PSIG with Union Tail Piece



125-LWUBP

Features

- Tamper resistant lockwing cap
- 2 Viton® o-rings
- Full port design to accommodate industry leading stop changers
- Lockwing accommodates standard barrel locks
- Maintenance free design
- 100% leak tested
- 100% Made in Italy
- Leakproof stem - Lifetime Warranty
- Patented security shutter and lockwing tab
 - US Patent no. 6,648,009

Approvals

- Meets or exceeds applicable part of DOT 192 and ANSI B16.33
- MSS SP-110

Pressure Rating

- 125 PSIG
- Temp range: -40°F to 300°F

WARNING: This product can expose you to chemicals including lead, which is known to the State of California to cause cancer, and lead, which is known to the State of California to cause birth defects or other reproductive harm. For more information go to www.P65Warnings.ca.gov.

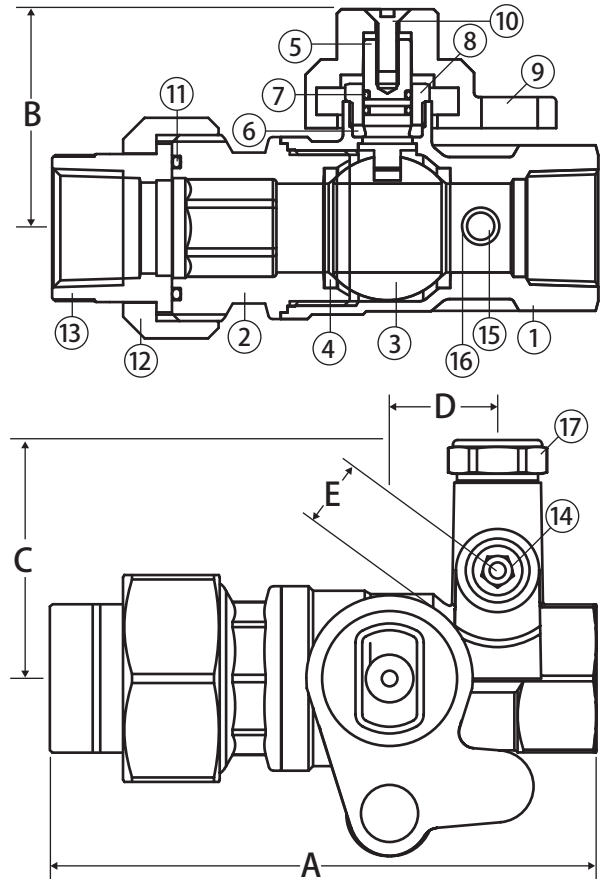

Material Specifications

| No. | Part | Materials |
|-----|------------------|------------------------------|
| 1 | Body* | Brass - CW617N |
| 2 | End Connection* | Brass - CW617N |
| 3 | Ball | Chrome Plated Brass - CW617N |
| 4 | Seat (2) | Hostaflo® TFM 1600 |
| 5 | Stem | Brass - CW614N |
| 6 | Packing | Buna-N |
| 7 | Stem O-ring (2) | Viton® |
| 8 | Packing Gland | Brass - CW614N |
| 9 | Lockwing Cap* | Brass - CW617N |
| 10 | Screw | 304 Stainless Steel |
| 11 | Union O-ring | Viton® |
| 12 | Union Nut* | Brass - CW617N |
| 13 | Tail Piece* | Brass - CW614N |
| 14 | Bypass Plug* | Brass - CW614N |
| 15 | Bypass Set Screw | Brass - CW614N |
| 16 | Bypass O-ring | Viton® |
| 17 | Bypass Cap* | Brass - CW614N |

*Component may be AGA painted depending upon selection

Dimensions

| Part No. | Size | A | B | C | D | E |
|----------|------|------|------|------|------|------|
| 244-105_ | 1" | 4.50 | 2.21 | 2.18 | 0.95 | 0.59 |

_ = Specify coating: B = Brass, P = Painted