

Brass Ball Valve

2 Piece, Full Port, MIP x FIP Connection, 600 WOG

JF-100TFM

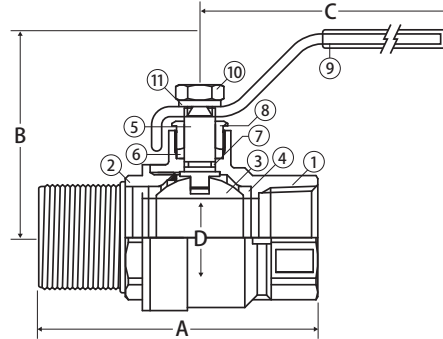

FEATURES

- Gland Follower and Single O-Ring Stem Design
- Blow-Out Proof Stem
- 100% Leak Tested
- 29 in-Hg Vacuum Rating

CERTIFICATIONS/APPROVALS

UL Listed up to 175 PSI

- MHKZ - Manual Valves
- YRPV - Gas Shut-Off Valves

MSS SP-110
ANSI B1.20.1
FM Approval (1/4"-2")

VALVE SEAT RATING

600 WOG - 150 WSP

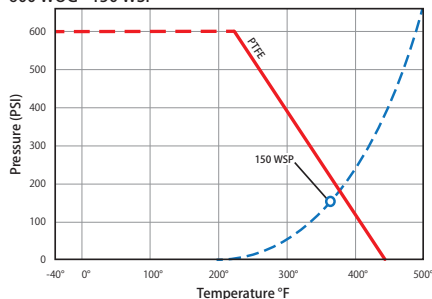

MATERIALS

No.	Part	Material
1	Body	Brass - C37700
2	End Connection	Brass - C37700
3	Ball	Chrome Plated Brass - C37700
4	Seat (2)	PTFE
5	Stem	Brass - C37700
6	Packing	PTFE
7	Stem O-Ring	Buna-N
8	Packing Gland	Brass - C37700
9	Handle	Steel - Chrome Plated
10	Handle Nut	Steel - Chrome Plated
11	Lock Washer	Steel - Chrome Plated

DIMENSIONS

Part No	Size	A	B	C	D
100-131	1/4"	2.05	1.69	3.54	0.39
100-132	3/8"	2.13	1.69	3.54	0.39
100-133	1/2"	2.5	1.81	3.54	0.59
100-134	3/4"	3	2.12	4.55	0.75
100-135	1"	3.27	2.25	4.55	0.98