

3 Piece 4 Bolt • Threaded & Flanged Connections

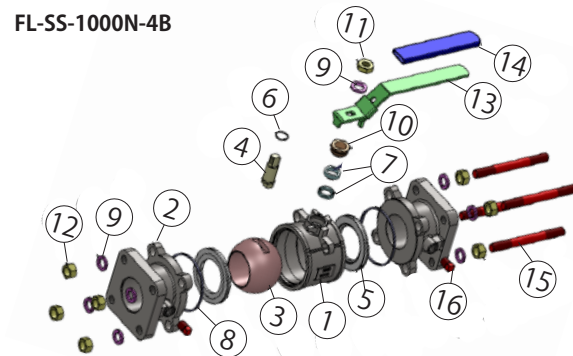
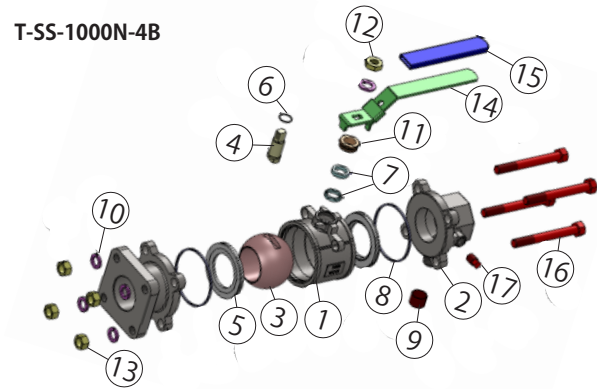

Installation:

1. The valve may be installed for flow in either direction. Use standard piping practices when installing valves with threaded parts. When tightening the valve to the pipe, apply the wrench to the end cap nearest the pipe being worked. Adjust packing prior to installation.
2. When installing the above valves, be sure that the threads on the mating pipe are free from excessive grit, dirt or burrs.
3. Take care to assure that any pipe sealants used are not excessively applied to the pipe threads that the valve seats, ball and/or cavity becomes fouled.

Operation:

1. The valve shall be within the temperature ranges from 14°F to 320°F and shall not be used in an environment outside this range.
2. The valve pressure rating is cast on the valve body; user shall make sure the fluid pressure does not exceed the valve's rated pressure.
3. Any inappropriate operation may cause leakage or other problems; in case of emergency, you must release the fluid inside the pipeline and then follow the procedures.
4. Operating torques shall not exceed the data shown on the Torque Table. Over-torquing can bend the stem, causing operational failure.

Maintenance:

Periodically observe the valve to be sure of proper performance. More frequent observation is recommended under extreme operating conditions. Routine maintenance consists of tightening the stem nut 1/4 turn periodically to compensate for the wear caused by the stem's turning against the resilient stem packing seal.

Disassembly:

NOTE: If complete disassembly becomes necessary, replacement of all seats and seals is recommended.

1. Unscrew the cap nut, remove the spring washer, cap bolt, and body cap.
2. Take out the seat, ball, and union seal.
3. Remove the handle nut, spring washer, handle, and gland. Then press the stem from the top into the valve body and remove it through the body.
4. Remove the stem seal and stem packing from stem.

Assembly:

The following instructions are for in-line assembly. For bench assembly, it may be more convenient.

1. Air-blast the valve body. Insert the stem seal into the stem. Then insert the stem into the stem bore and up out the top of the valve.
2. Place a wrench through the body on the bottom of the stem blade to hold the stem stationary. Then, install the stem packing and gland into the stem and tighten the gland until snug.
3. Align the stem blade inside the valve body with the ball. Insert the ball and rotate the stem to the fully closed position.
4. Working at either end of the valve body, place a seat into the valve body. Push the seat snugly against the closed ball.
5. Place a union seal into the machined sealing groove of the body. Be certain the groove and seal are clean.
6. Repeat step 4 and 5 for assembly of the opposite end of the valve.
7. Turn the stem to the fully open position.
8. Swing the entire body assembly back into the properly aligned and interlocked position between the body caps, being careful not to scratch the union seals. The body caps may have to be spread slightly to accept the valve body.
9. Close the valve.
10. Bolt the valve together with cap bolts, spring washers, and cap nuts. Tighten the nuts evenly, alternating between them to the torque listed in Torque Table.
11. Turn the ball one revolution at least once.
12. Place the handle, and spring washer and handle nut over the stem. Insert the plug into the 1/4" FNPT port. Tighten the handle nut and plug until snug.
13. Cycle the valve slowly twice to ensure permanent position of the ball between the two seats.

Size	Torque	
	Cap Nut Torque	Maximum Operating Torque
2"	561	600

Material Specifications		
T-SS-1000N-4B	Part	FL-SS-1000N-4B
1	Body	1
2	Body Cap (2)	2
3	Ball	3
4	Stem	4
5	Seat (2)	5
6	Stem Seal	6
7	Stem Packing	7
8	Union Seal (2)	8
9	Protection Cover	-
10	Spring Washer	9
11	Gland	10
12	Handle Nut	11
13	Cap Nut	12
14	Handle	13
15	Plastic	14
16	Cap Bolt	15
17	Plug	16

Warning:

For your safety, it is important that the following precautions be taken prior to removal of the valve from the line or before any disassembly.

1. Wear any protective clothing or equipment normally required when working with the fluid involved.
2. De-pressurize the line and cycle the valve as follows:
 - A. Place the valve in the open position and drain the line
 - B. Cycle the valve to relieve residual pressure in the body cavity before removing the valve from the line.
 - C. After removal and before any disassembly, cycle the valve again several times.
3. This valve is not to be used for unstable gases, H_2SO_4 , HF, HCl, and other dangerous fluids. If you have questions regarding the used fluid, please contact Jomar Valve at csr@jomar.com or (586) 268-1220.