



# Bronze Check Valve

Solder Connection, Swing, Y-Pattern, 300 WOG, Class 150

S-511



### FEATURES

Can be Installed in Vertical or Horizontal Positions  
Residential and Commercial Applications

### CERTIFICATIONS/APPROVALS

MSS SP-80  
ASME/ANSI B16.18

### VALVE SEAT RATING

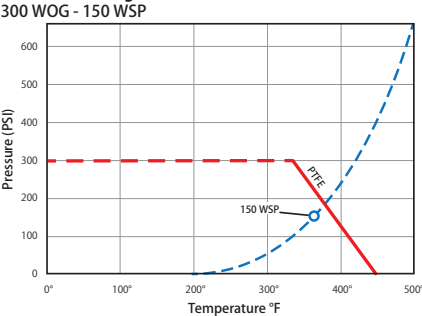

Install 5 pipe diameters minimum downstream from pump discharge or changes in direction to avoid flow turbulence. Flow straighteners may be required in extreme cases.

Note: On pump discharge, the preferred check valves are: inline, spring assisted, center-guided, lift checks.

Jomar Check Valves may be installed in both horizontal and vertical lines with upward flow or in an intermediate position. They will operate satisfactory in a declining plane (no more than 15°).

**Warning: Do Not Use For Reciprocating Air Compressor Service**

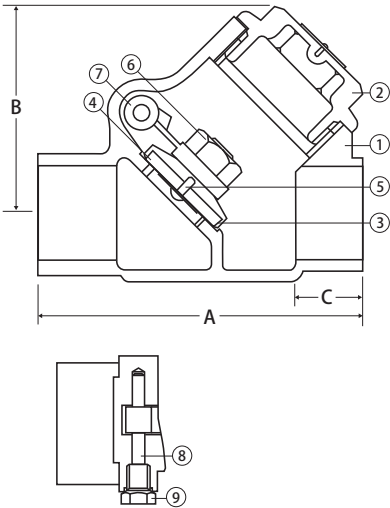

### MATERIALS

| No. | Part        | Material |
|-----|-------------|----------|
| 1   | Body        | Bronze   |
| 2   | Cap         | Bronze   |
| 3   | Disc        | Bronze   |
| 4   | Seat        | PTFE     |
| 5   | Seat Screw  | Brass    |
| 6   | Seat Nut    | Brass    |
| 7   | Hinge Arm   | Bronze   |
| 8   | Hinge Pin   | Brass    |
| 9   | Hinge Screw | Brass    |

### DIMENSIONS

| Part No | Size   | A    | B    | C    | Cv    | Cracking Pressure (PSI) |
|---------|--------|------|------|------|-------|-------------------------|
| 105-403 | 1/2"   | 2.60 | 1.77 | 0.50 | 11.86 | 0.0134                  |
| 105-404 | 3/4"   | 3.39 | 1.97 | 0.75 | 14.25 | 0.0125                  |
| 105-405 | 1"     | 4.09 | 2.28 | 0.91 | 24.33 | 0.0109                  |
| 105-406 | 1-1/4" | 4.72 | 2.67 | 0.97 | 32.37 | 0.012                   |
| 105-407 | 1-1/2" | 5.39 | 2.95 | 1.09 | 47.53 | 0.0118                  |
| 105-408 | 2"     | 6.69 | 3.70 | 1.34 | 55.28 | 0.0112                  |
| 105-409 | 2-1/2" | 7.64 | 4.55 | 1.47 |       |                         |
| 105-410 | 3"     | 8.74 | 5.37 | 1.66 |       |                         |

**WARNING:** This product can expose you to chemicals including lead, which is known to the State of California to cause cancer, birth defects or other reproductive harm. For more information go to [www.P65Warnings.ca.gov](http://www.P65Warnings.ca.gov).