

Lead Free Brass Ball Valve



2 Piece • Standard Port • Threaded Female x Crimp Pex Connection • 600 WOG



T-412G FIP

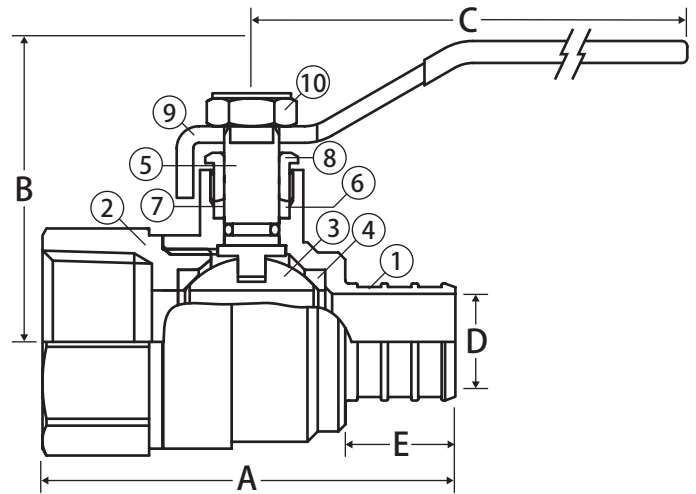

Features

- Gland follower and single o-ring stem design
- Blow-out proof stem
- 100% leak tested
- Wetted surfaces contain less than .25% lead content

Approvals

- ASTM F1807
- CSA Certified
 - ASME A112.4.14
- IAPMO Certified
 - NSF 61-8
 - NSF 372
 - Uniform Plumbing Code (cUPC)
 - IAPMO/ANSI Z1157-2014
 - NSF/ANSI 14-2014
- ANSI B1.20.1

Pressure Rating

- Body rated to 600 WOG
- Crimp connection rated to 100 WOG up to 180°F



WARNING: This product can expose you to chemicals including lead, which is known to the State of California to cause cancer, and lead, which is known to the State of California to cause birth defects or other reproductive harm. For more information go to www.P65Warnings.ca.gov.

Material Specifications

| No. | Part | Materials |
|-----|----------------|--------------------------|
| 1 | Body | Lead Free Brass - C46400 |
| 2 | End Connection | Lead Free Brass - C46400 |
| 3 | Ball | 304 Stainless Steel |
| 4 | Seat (2) | PTFE |
| 5 | Stem | 304 Stainless Steel |
| 6 | Packing | PTFE |
| 7 | Stem O-ring | Buna-N |
| 8 | Packing Gland | Lead Free Brass - C46400 |
| 9 | Handle | Steel - Chrome Plated |
| 10 | Handle Nut | Steel - Chrome Plated |
| 11 | Lock Washer | Steel - Chrome Plated |

Dimensions

| Part No. | Size | A | B | C | D | E |
|-----------|------|------|------|------|------|------|
| 103-554PG | 3/4" | 2.32 | 1.81 | 3.35 | 0.53 | 0.63 |
| 103-555PG | 1" | 2.89 | 2.09 | 4.29 | 0.71 | 0.80 |