

Lead Free Brass Sillcock



Quarter-Turn Frost Free Sillcock with Integral Vacuum Breaker



T-540G

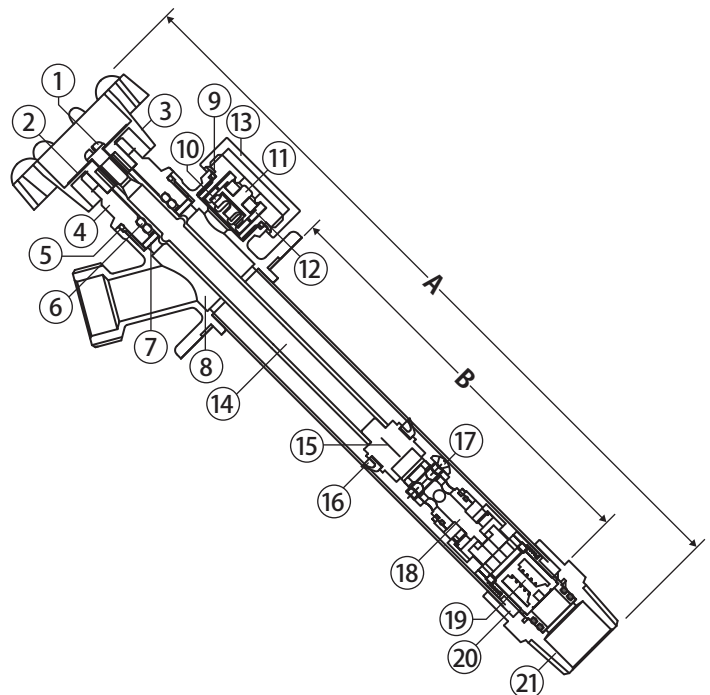

Features

- Lead Free dezincification resistant brass
- 1/4-turn positive shut-off
- Integral check valve protecting against back flow
- Integral vacuum breaker protecting against back siphoning
- Angled notched flange for easy installation and draining
- Lock-shield design
- MNPT ends have 1/2" copper solder inside
- MNPT slot and PEX end options
- Complies with ASSE 1019, ASME A112.18 & CSA B1215.1
- Replacement cartridges available

Approvals



- IAPMO Certified
 - NSF 372
 - NSF/ANSI 61
- ANSI B1.20.1
- ANSI B1.20.7
- ANSI B16.18

Dimensions

Part No.	Size	A	B
MIP and Solder End			
202-202G	1/2" x 6"	10.63	6.00
202-203G	1/2" x 8"	12.63	8.00
202-204G	1/2" x 10"	14.63	10.00
202-205G	1/2" x 12"	16.63	12.00
202-206G	1/2" x 14"	18.63	14.00
PEX End			
202-202PEG	1/2" x 6"	11.37	6.00
202-203PEG	1/2" x 8"	13.37	8.00
202-204PEG	1/2" x 10"	15.38	10.00
202-205PEG	1/2" x 12"	17.37	12.00

Material Specifications

No.	Part	Materials
1	Screw	SS304
2	Label	Aluminum
3	Handle	AL Alloy
4	Bonnet	Chrome Plated LF Brass
5	O-ring	EPDM
6	O-ring	EPDM
7	Washer	SS304
8	Body	Chrome Plated LF Brass
9	O-ring	EPDM
10	Vacuum Breaker Seat	EPDM
11	Vacuum Breaker Disc	POM
12	Vacuum Breaker Body	POM
13	Vacuum Breaker Cap	Chrome Plated ABS
14	Stem	Brass
15	Stem	LF Brass
16	Packing	EPDM
17	Set Screw	SS304
18	Cartridge	Ceramic + LF Brass
19	Check Valve	POM
20	Tube	Chrome Plated Brass
21	Adapter	Chrome Plated LF Brass



WARNING: This product can expose you to chemicals including lead, which is known to the State of California to cause cancer, and lead, which is known to the State of California to cause birth defects or other reproductive harm. For more information go to www.P65Warnings.ca.gov.