

# Domestic Hot Water Balancing Valve

RecircSetter™ | Thermostatic Balancing, Variable Set Point, 150 CWP

**TB-110G**



## FEATURES

- Dezincification Resistant Brass Alloy
- Variable Temperature Set Point with Protective Cap
- Modulates Flow to Maintain Constant Temperature in Recirculation Loop
- No Balancing Equipment Required
- Drywell with Temperature Gauge Comes Standard
- Thermal Detection Bypass (160°F)
- 100% Made in Italy
- NSF 61 & NSF 372 Certified
- Wetted Surfaces Contain Less than .25% Lead Content

## CERTIFICATIONS/APPROVALS

- NSF/ANSI/CAN 61
- NSF/ANSI/CAN 372
- Conforms to ANSI B1.20.1

## PRESSURE/TEMPERATURE RATING

- Max Working Pressure: 232 psi
- Max Differential Pressure: 14.5 psi
- Max Working Temperature: 194°F
- Temperature Setting Range: 100°F - 136°F

$C_{vmin}$ : 0.578

$C_{vmax}$ : 4.97

$C_{vdisin}$ : 2.312

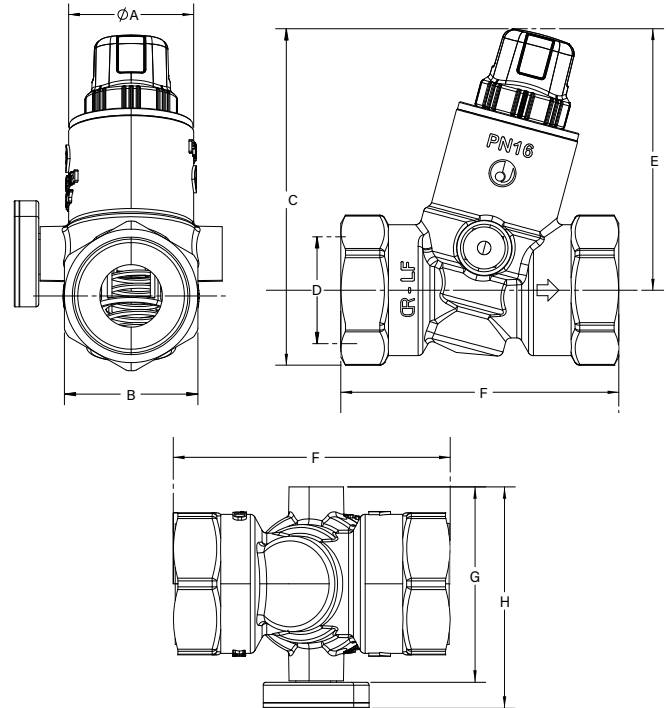

## DIMENSIONS

Part No	Size	A	B	C	D	E	F	G	H
180-105G	1"	1.81	1.93	4.86	1.18	3.78	4.02	2.66	3.01
180-106G	1-1/4"	1.81	1.93	4.86	1.54	3.78	4.02	2.66	3.01

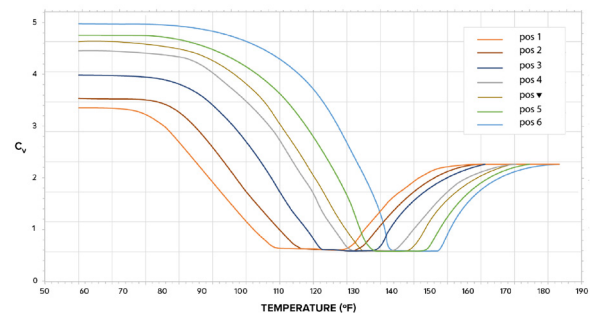

HAND WHEEL SETPOINT TEMPERATURE (°F)					
100°	104°	113°	122°	125°	131°
1	2	3	4	▼	5
					6

## Material Specifications

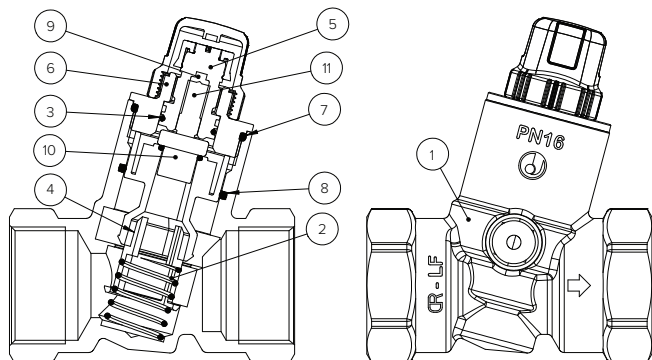

### MATERIALS

No.	Part	Material
1	Valve Body	LF DZR Brass C27453
2	Spring	Stainless Steel AISI 302
3	O-Ring	EPDM
4	Shutter	PSU
5	Stem	LF DZR Brass C27453
6	Stem Adapter	LF DZR Brass C27453
7	O-Ring	EPDM
8	O-Ring	EPDM
9	Cartridge Piston	Steel
10	Cartridge Cup	Copper
11	Cartridge Sleeve	EPDM



WARNING: This product can expose you to chemicals including lead, which is known to the State of California to cause cancer, birth defects or other reproductive harm. For more information go to [www.P65Warnings.ca.gov](http://www.P65Warnings.ca.gov).